

NOTE: This annotated drawing is for information only and does not form part of the application.

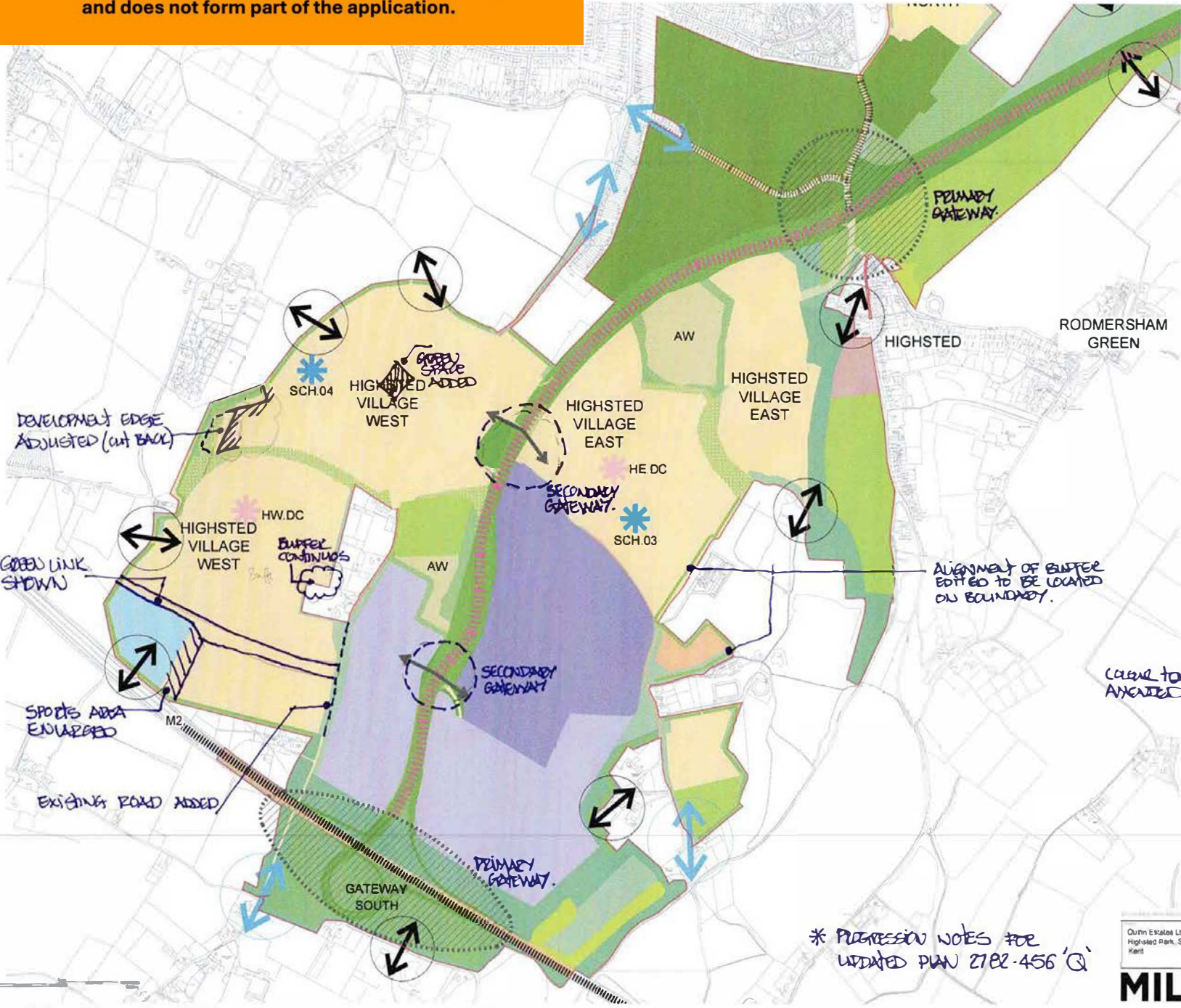

NOTES:
 * 'CONNECTION' SYMBOLS REDUCED IN SIZE

SET	
[Red line]	Development Boundary
[Yellow fill]	Development Area - Residential and Mixed Use
[Light blue fill]	Development Area - Commercial and Sunspace
[Purple fill]	Existing Sports Park
[Orange fill]	Community Groups
[Green fill]	Household Waste Recycling Centre
[Light green fill]	Open Space - Eco Park
[Dark green fill]	Open Space - Country Parks (Parkland)
[Light blue fill]	Open Space - Sport and Recreation
[Green fill]	Existing Woodland
[Light green fill]	Adjacent Woodland
[Dark green fill]	Proposed Woodland
[Green line]	Proposed Landscape Buffer
[Light green fill]	Open Space - Amenity
[Blue star]	Primary School
[Light blue star]	Secondary School
[Pink star]	District Centre
[Green circle]	Gateway Access Point
[Blue circle]	Garage Access Point
[Green line]	Primary Route - BPR
[Blue arrow]	Footway Cyclepath/Bridleway Connection

* PROGRESSION NOTES FOR UPDATED PLAN 2782-456 'Q'

Quinn Estates Ltd
 Highsted Park, Sangbourn
 Kent

Parameter Plan Development
 Highsted
 1:5,000 @ A1
 September 2022

DC11
 2782-456P

MILTONSTUDIO

NOTE: This annotated drawing is for information only and does not form part of the application.

SITTINGBOURNE

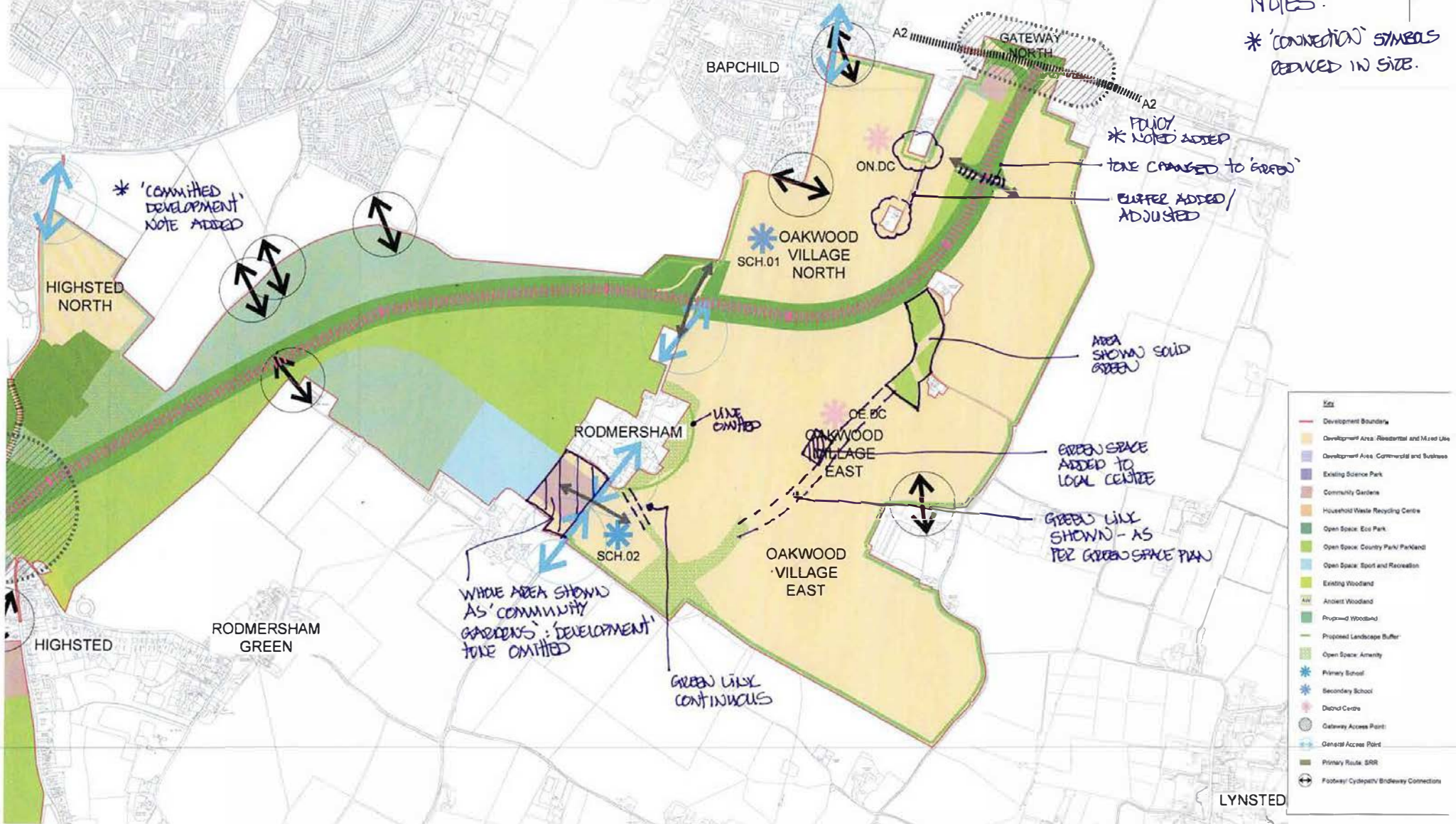

NOTES:
* 'CONNECTION' SYMBOLS REDUCED IN SIZE.

* 'COMMITTED DEVELOPMENT' NOTE ADDED

POLICY * NOTED ADDED
TONE CHANGED TO 'GREEN'
BUFFER ADDED/ ADJUSTED

AREA SHOWN SOLID GREEN

GREEN SPACE ADDED TO LOCAL CENTRE

GREEN LINK SHOWN - AS PER GREEN SPACE PLAN

WHOLE AREA SHOWN AS 'COMMUNITY GARDENS': DEVELOPMENT TONE OMITTED

GREEN LINK CONTINUOUS

* PROGRESSION NOTES FOR UPDATED PLAN 2782-457 'G'

Quinn Estates Ltd Highsted Park, Sittingbourne Kent	Parameter Plan: Development Oakwood 1:5,000 @ A1 September 2022	100% 2782-457P
---	--	-------------------

MILTONSTUDIO



NOTE: This annotated drawing is for information only and does not form part of the application.

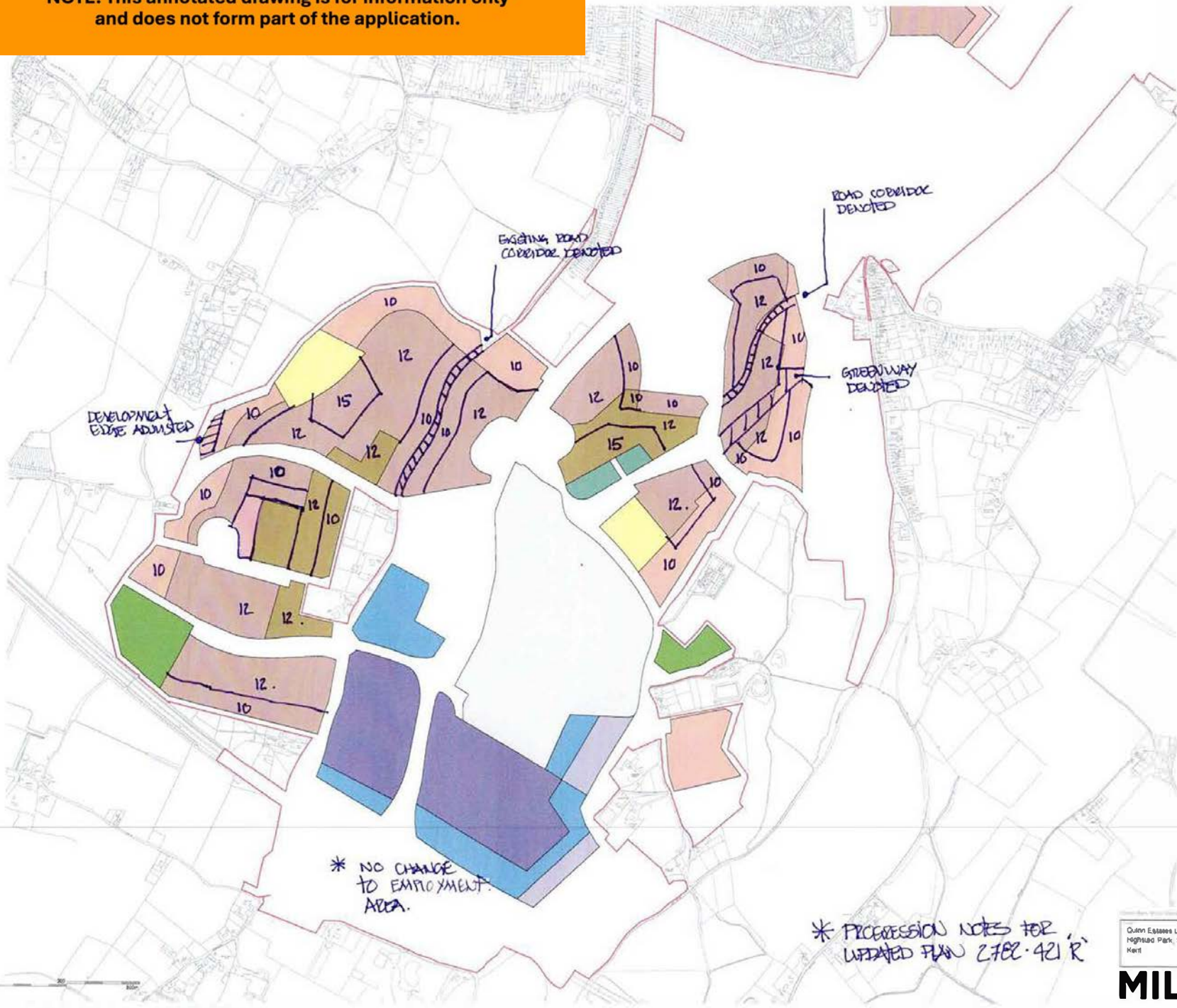

* BUILDING HEIGHT ZONES GENERALLY ADJUSTED - TO REFLECT COMMENTS FROM URBAN DESIGN

* NO CHANGE TO EMPLOYMENT AREA.

* PROGRESSION NOTES FOR UPDATED PLAN 2 FEB 2021 R

Key

	Development Boundary
	Mixed Use & Residential Up to 15m
	Mixed Use, High Residential, Up to 10m
	Residential, Up to 15m
	Residential, Up to 12m
	Residential, Up to 10m
	Office, Up to 12m
	Employment, Up to 18.5m
	Employment, Up to 13.25m
	Employment, Up to 10m
	Existing Employment
	Above existing ground level

Quinn Estates Ltd Highgate Park, Sengbourne Kerr	Parametric Plan: Built Form Heights, Highgate 1:5,000 @ A1 March 2021	DCH 2782-421Q
--	---	------------------

MILTON STUDIO

NOTE: This annotated drawing is for information only and does not form part of the application.

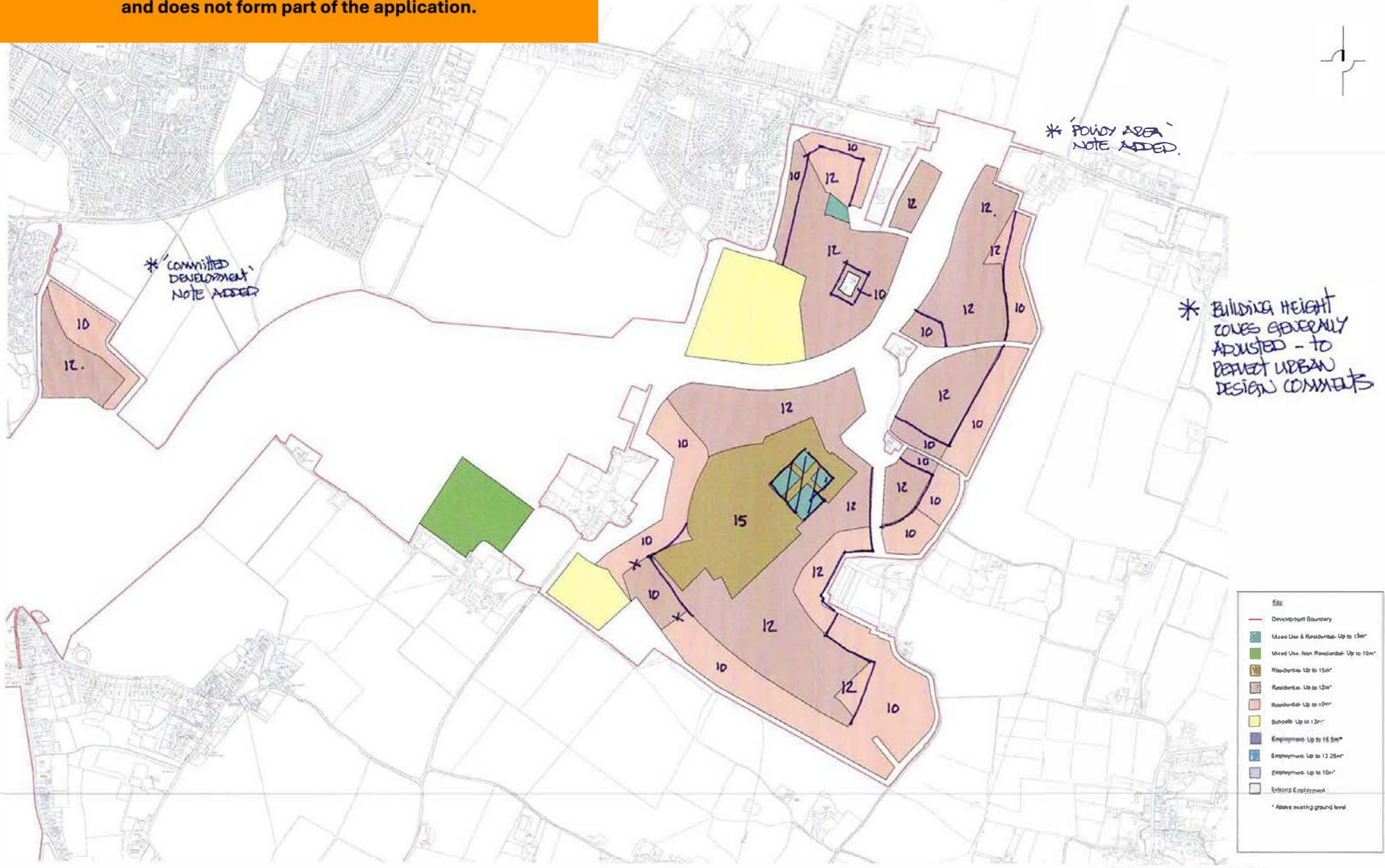

Site

- Development Boundary
- Use: Use & Residential: Up to 15m*
- Use: Use Non Residential: Up to 10m*
- Residential: Up to 10m*
- Residential: Up to 12m*
- Residential: Up to 10m*
- Schools: Up to 12m*
- Employment: Up to 15.5m*
- Employment: Up to 13.25m*
- Employment: Up to 10m*
- EV/HS Employment

* Above existing ground level



* PROGRESSION NOTES FOR
UPDATED PLAN 2782-422 'R'

Quinn Estates Ltd Higsted Park, Slingsbourne Ken	Parameter Plan: Bull Form Heights, Ollinwood 1:5,000 @ A1 March 2021	DPH 2782-422Q
--	---	------------------

MILTONSTUDIO

NOTE: This annotated drawing is for information only and does not form part of the application.

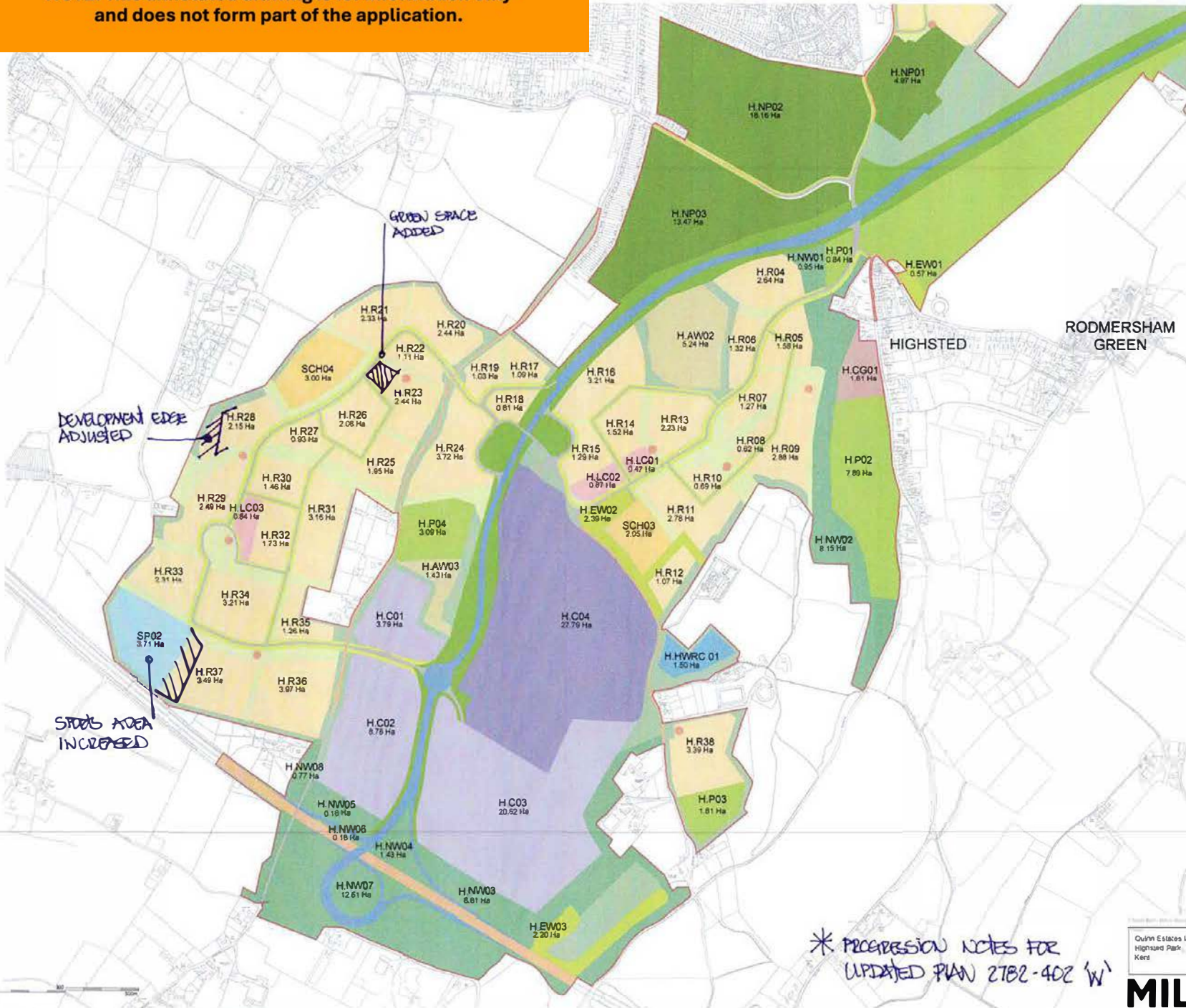

Key	(Overall ha)
Development Boundary	577.48 Ha
Community Gardens	14.58 Ha
Residential	167.14 Ha
Commercial	23.78 Ha
Local Centre & Mixed Use	4.09 Ha
Existing KSP Development	27.78 Ha
Schools	17.05 Ha
Sports	8.10 Ha
Strategic Play Areas (notable)	4.90 Ha
Amenity Greenspace	20.30 Ha
Arable Woodland	8.87 Ha
Semi Natural Greenspace	58.58 Ha
Nature Park	28.02 Ha
New Woodland	24.31 Ha
Existing Woodland	5.15 Ha
Parkland	52.51 Ha
Highway Greenspace	17.85 Ha
Sustainable Movement Corridor Greenways	24.48 Ha
Roads - Existing	49.43 Ha
MBS Development Roads (Inclusive Alignment)	9.64 Ha
Southern Relief Road (SRD) (Inclusive Alignment)	15.74 Ha
Household Waste Recycling Centre	1.50 Ha

* PROGRESSION NOTES FOR
UPDATED PLAN 2782-402 'W'

Quinn Estates Ltd
Highsted Park, Sittingbourne
Kent

Development Structuring Plan,
Highsted
1:5,000 @ A1
September 2022

DCH
2782-402 'W'

MILTON STUDIO

NOTE: This annotated drawing is for information only and does not form part of the application.

SITTINGBOURNE

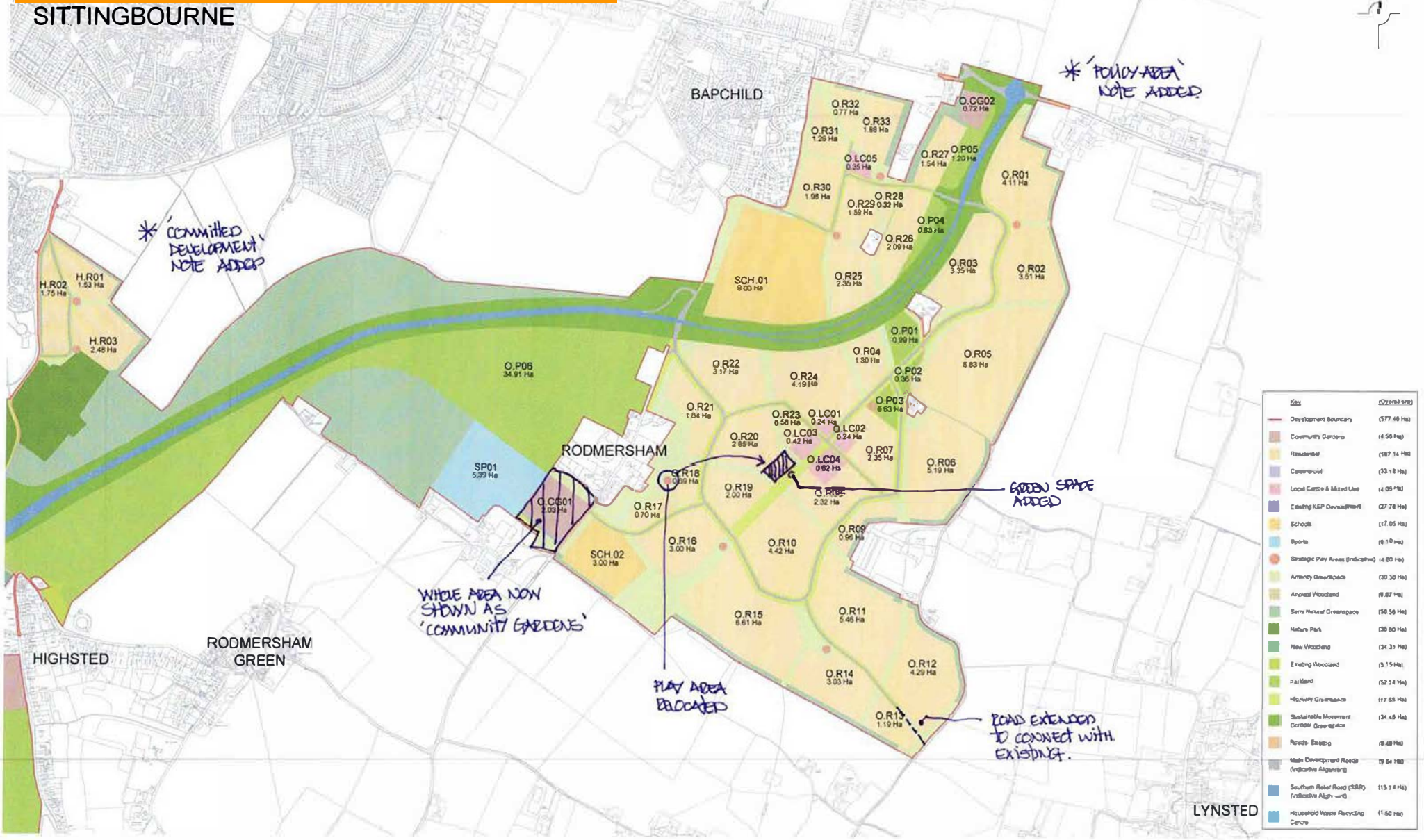

Key	(Overall site)
Development Boundary	577.46 Ha
Community Gardens	16.56 Ha
Residential	187.14 Ha
Commercial	33.18 Ha
Local Centre & Mixed Use	12.05 Ha
Existing K&P Development	27.78 Ha
Schools	17.05 Ha
Sports	8.19 Ha
Strategic Play Areas (Indicative)	14.80 Ha
Amenity Greenspace	30.30 Ha
Ancient Woodland	8.87 Ha
Some Natural Greenspace	56.56 Ha
Nature Park	38.60 Ha
New Woodland	24.31 Ha
Existing Woodland	15.15 Ha
Field	52.24 Ha
Highway Greenspace	17.65 Ha
Sustainable Movement Corridor Greenspace	24.48 Ha
Roads - Existing	8.48 Ha
Main Development Roads (Indicative Alignment)	19.84 Ha
Southern Relief Road (SRR) (Indicative Alignment)	113.74 Ha
Household Waste Recycling Centre	11.56 Ha



* PROGRESSION NOTES FOR UPDATED PLAN 2784-403 'W'

Quinn Estates Ltd Highsted Park, Sittingbourne Kent	Development Structuring Plan Oakwood 1:5,000 @ A1 September 2022	DCM 2782-403V
---	---	------------------

MILTON STUDIO

NOTE: This annotated drawing is for information only and does not form part of the application.

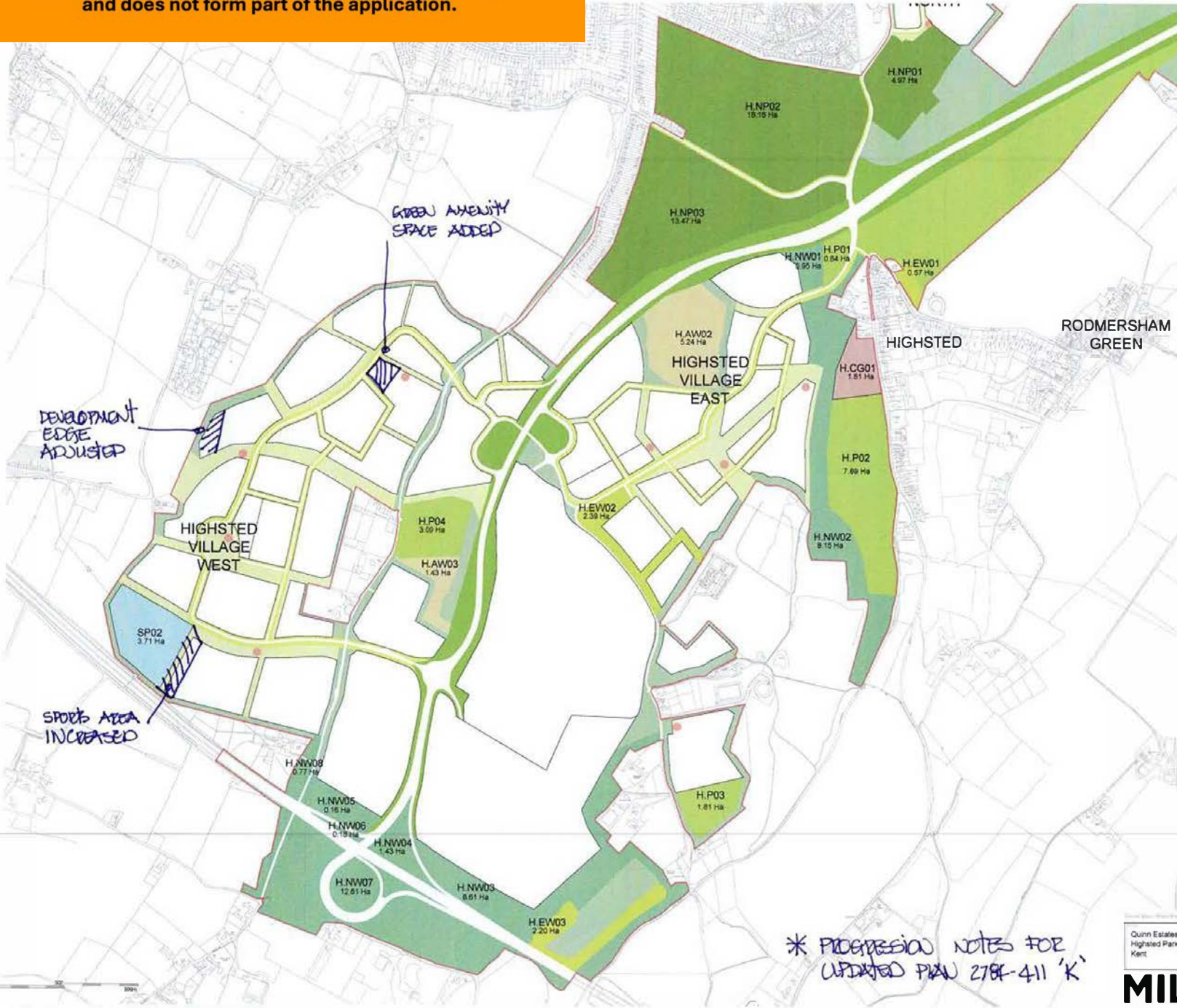

Key	(Overall site)
Development Boundary	(377.48 Ha)
Community Gardens	(4.98 Ha)
Spine	(8.15 Ha)
Strategic Play Area (Indicative)	(4.85 Ha)
Amenity Greenspace	(26.30 Ha)
Arboret Woodland	(5.87 Ha)
Berry Nature Greenspace	(58.56 Ha)
Nature Park	(36.05 Ha)
New Woodland	(34.21 Ha)
Existing Woodland	(5.15 Ha)
Parkland	(52.54 Ha)
Highway Greenspace	(17.25 Ha)
Sustainable Movement Corridor Greenspace	(34.49 Ha)
Development	

* PROGRESSION NOTES FOR UPDATED PLAN 2784-411 'K'

Quinn Estates Ltd Highsted Park, Sittingbourne Kent	Greenspace Structuring Plan: Highsted 1:5,000 @ A1 March 2021	DCM 2782-411.J
---	--	-------------------

MILTONSTUDIO



NOTE: This annotated drawing is for information only and does not form part of the application.

SITTINGBOURNE

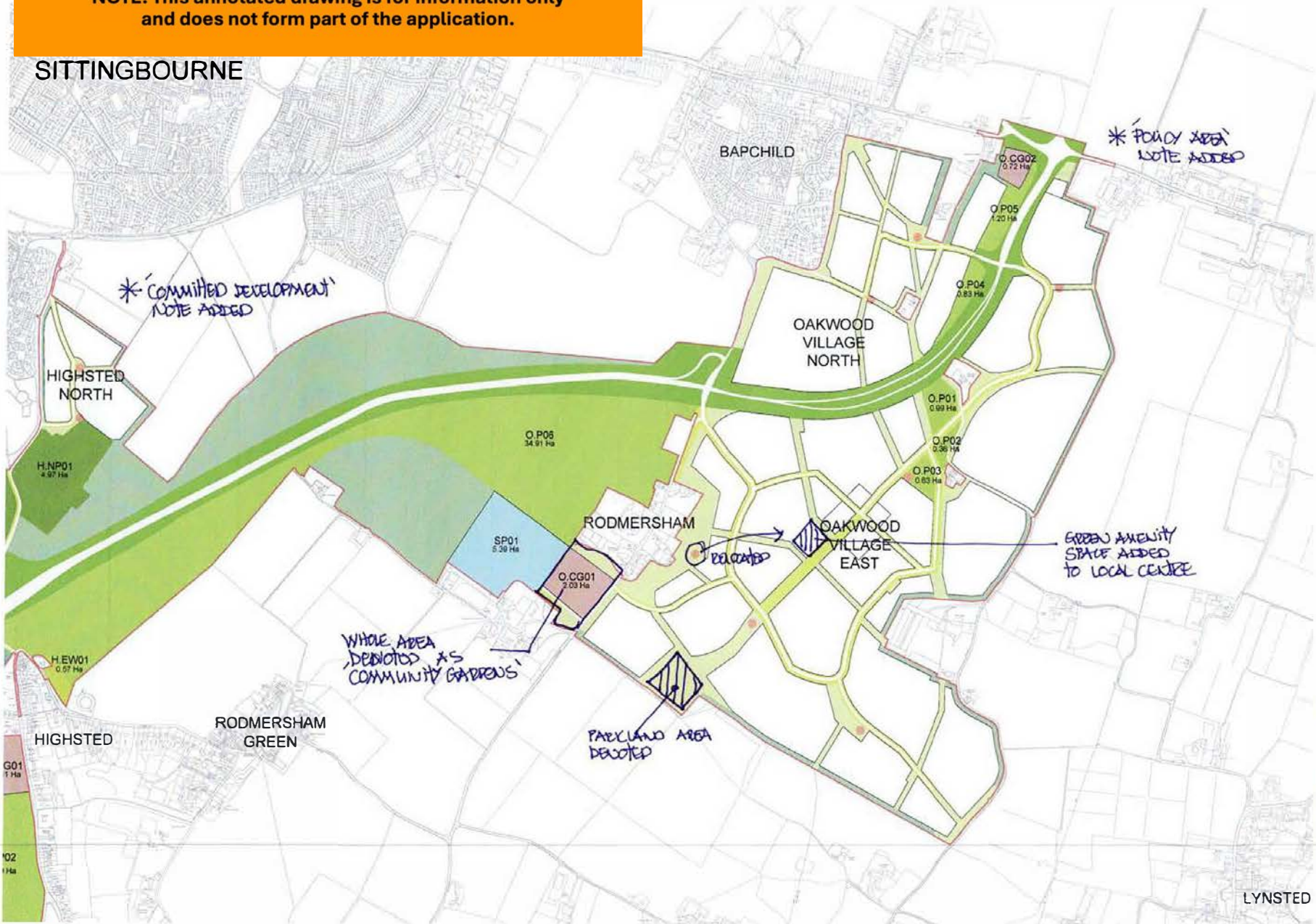

* PROGRESSION NOTES FOR
UPDATED PLAN 2784-412 'K'

Quinn Estates Ltd Highsted Park, Sittingbourne Kent	GreenSpace Structuring Plan Oakwood
1:5,000 @ A1	DCH
March 2021	2782-412 J

MILTONSTUDIO

NOTE: This annotated drawing is for information only and does not form part of the application.

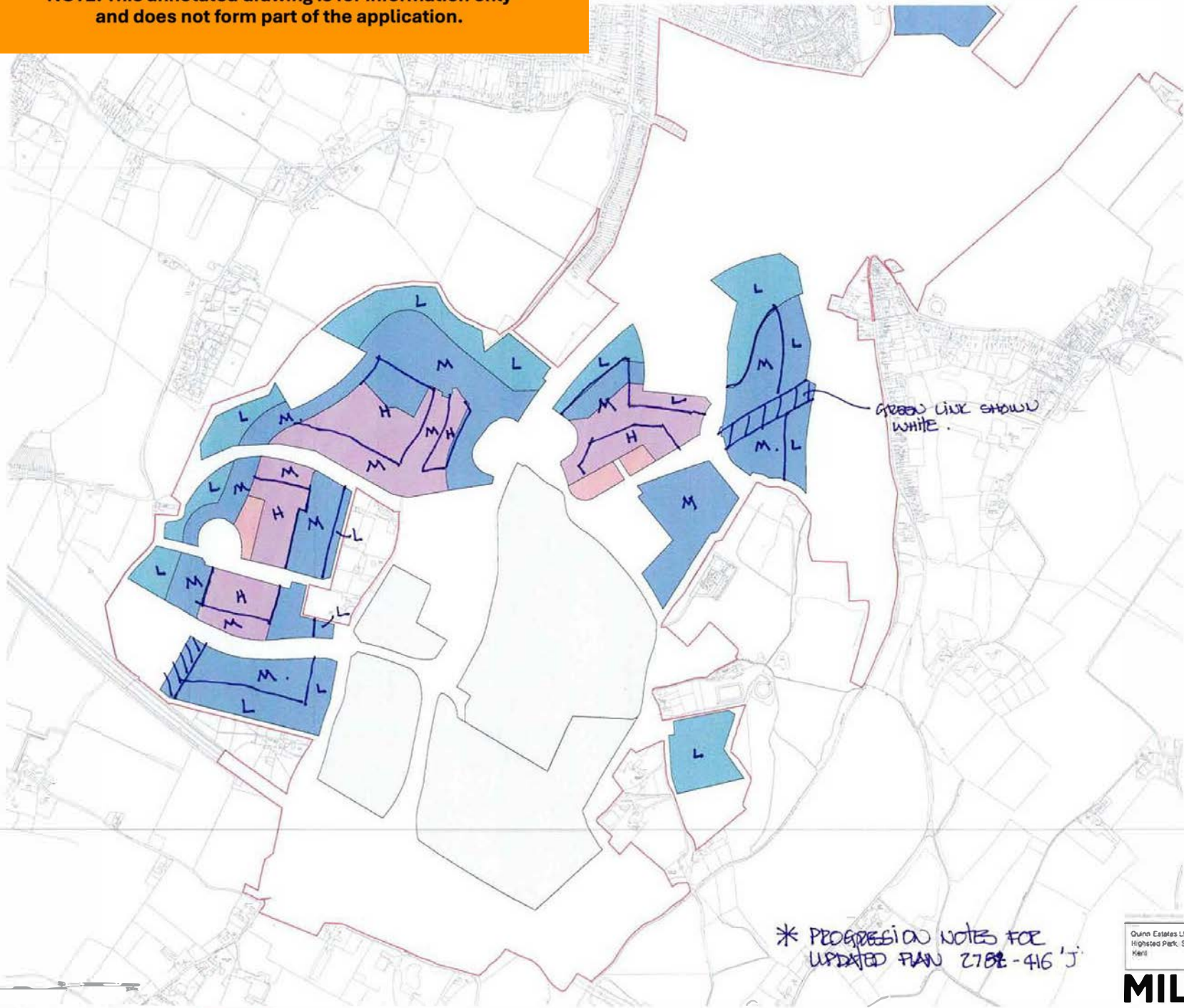

* DENSITY BANDS
GENERALLY ADJUSTED

GREEN LINE SHOWS
WHITE.

Siz	
Development Boundary	—
Local Centre & Mixed Use	■
Residential-High Density	■
Residential-Medium Density	■
Residential-Low Density	■
Non Residential Uses	■

* PROGRESSIVE NOTES FOR
UPDATED PLAN 2782-416 'J'

Quinn Estates Ltd Highsted Park, Stungbourne Kilri	Framework Plan Density_ Highsted 1:5,000 @ A1 March 2021	DCU 2782-416
--	---	-----------------

MILTONSTUDIO

NOTE: This annotated drawing is for information only and does not form part of the application.

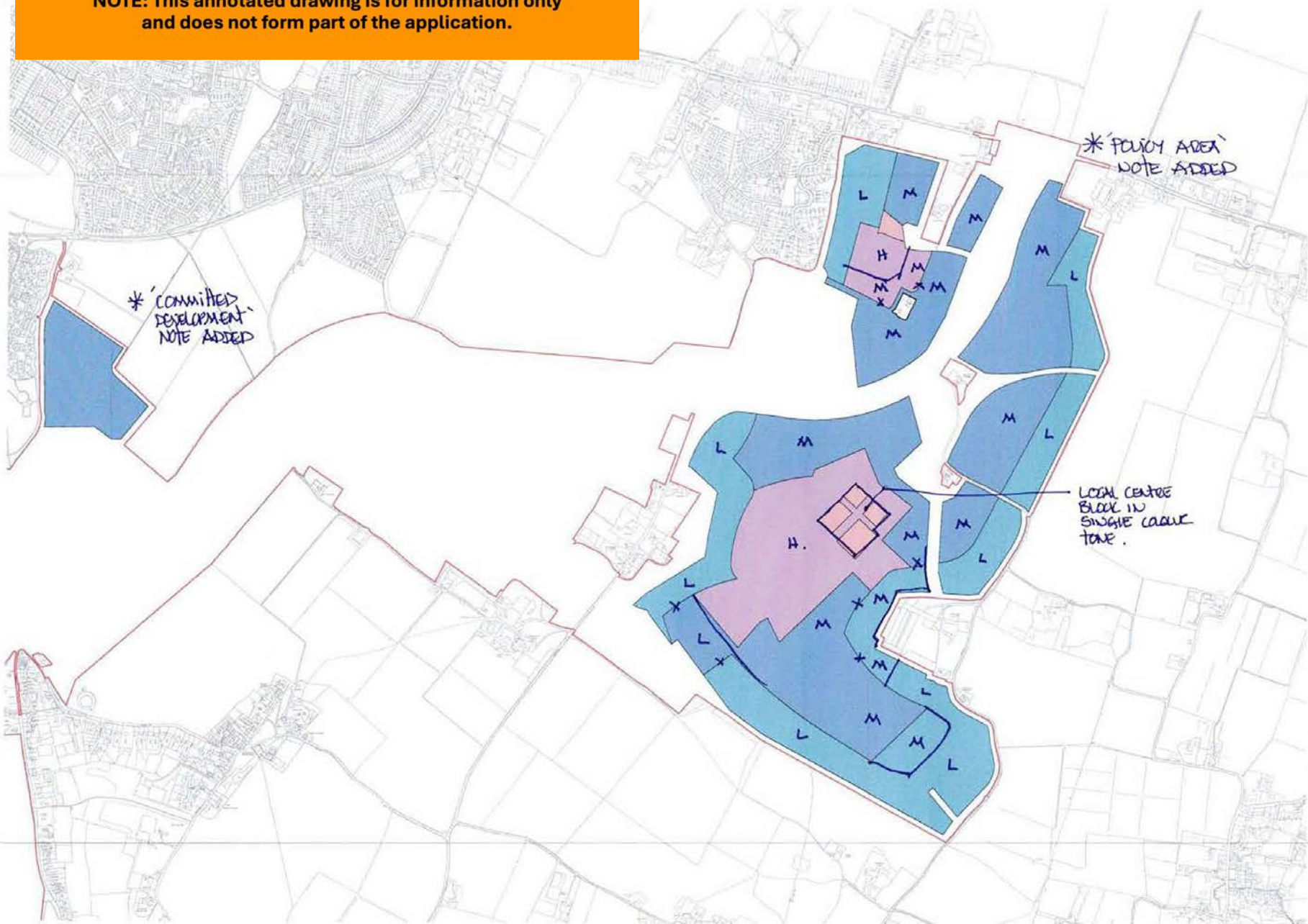

Site	
	Development Boundary
	Local Centre & Mixed Use
	Residential - Higher Density
	Residential - Medium Density
	Residential - Low Density
	Non Residential Use

* PROGRESSION NOTES FOR UPDATED PLAN 2782-417 'J'

Quinn Estates Ltd Highgate Park, Sittingbourne Kent	Framework Plan: Density Oakwood 1:5,000 @A1 March 2020	SCH 2782-417J
---	---	------------------

MILTONSTUDIO



NOTE: This annotated drawing is for information only and does not form part of the application.

SITTINGBOURNE

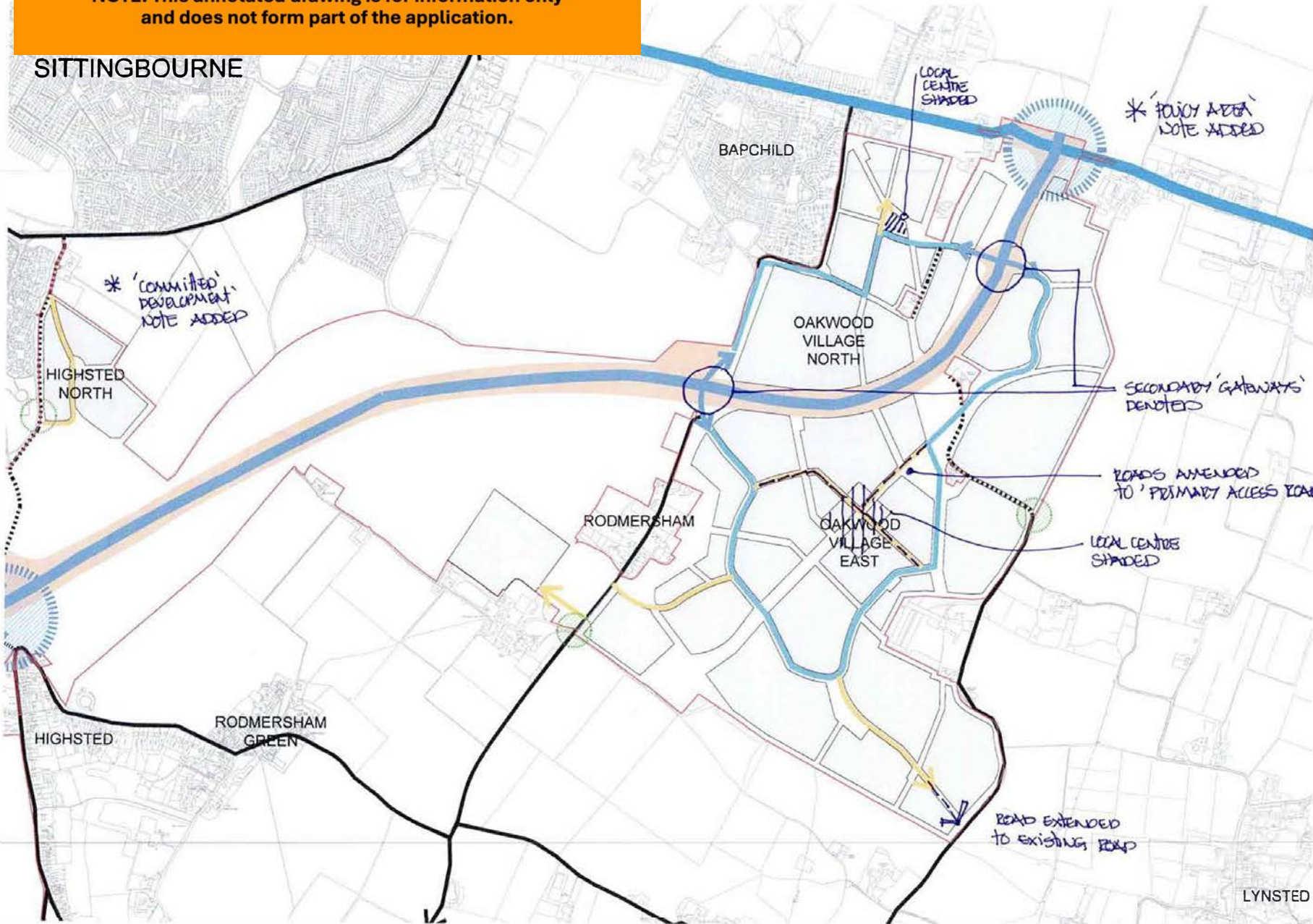

* PROGRESSION NOTES FOR
UPDATED PLAN 2782-427 'M'

Quinn Estates Ltd
Highsted Park, Sittingbourne
Kent

Framework Plan: Access and Strategic
Vehicular Routes - Oakwood
1:5,000 @ A1
DCH
March 2021 2782-427 L

MILTONSTUDIO

NOTE: This annotated drawing is for information only and does not form part of the application.

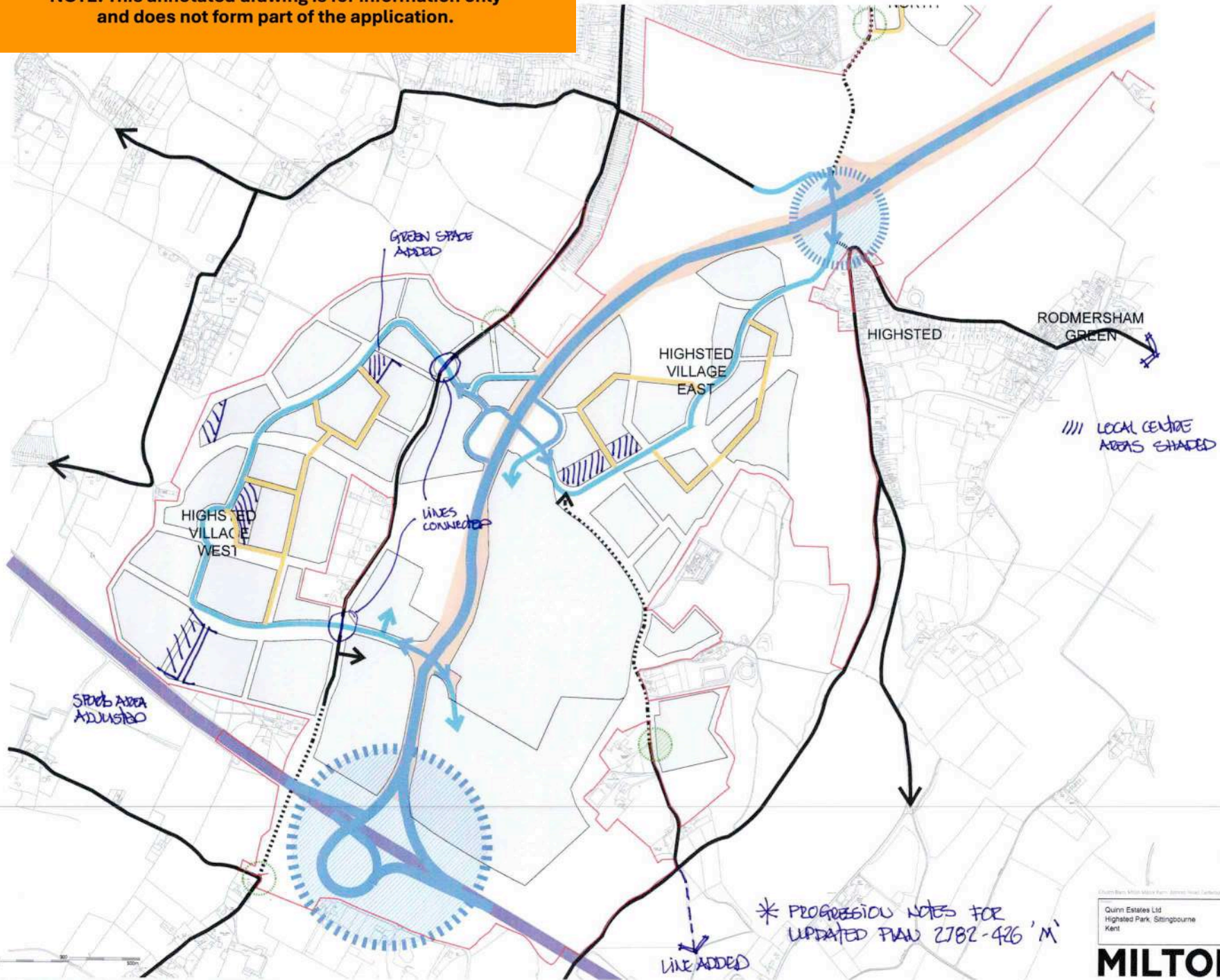

NOTE: This annotated drawing is for information only and does not form part of the application.

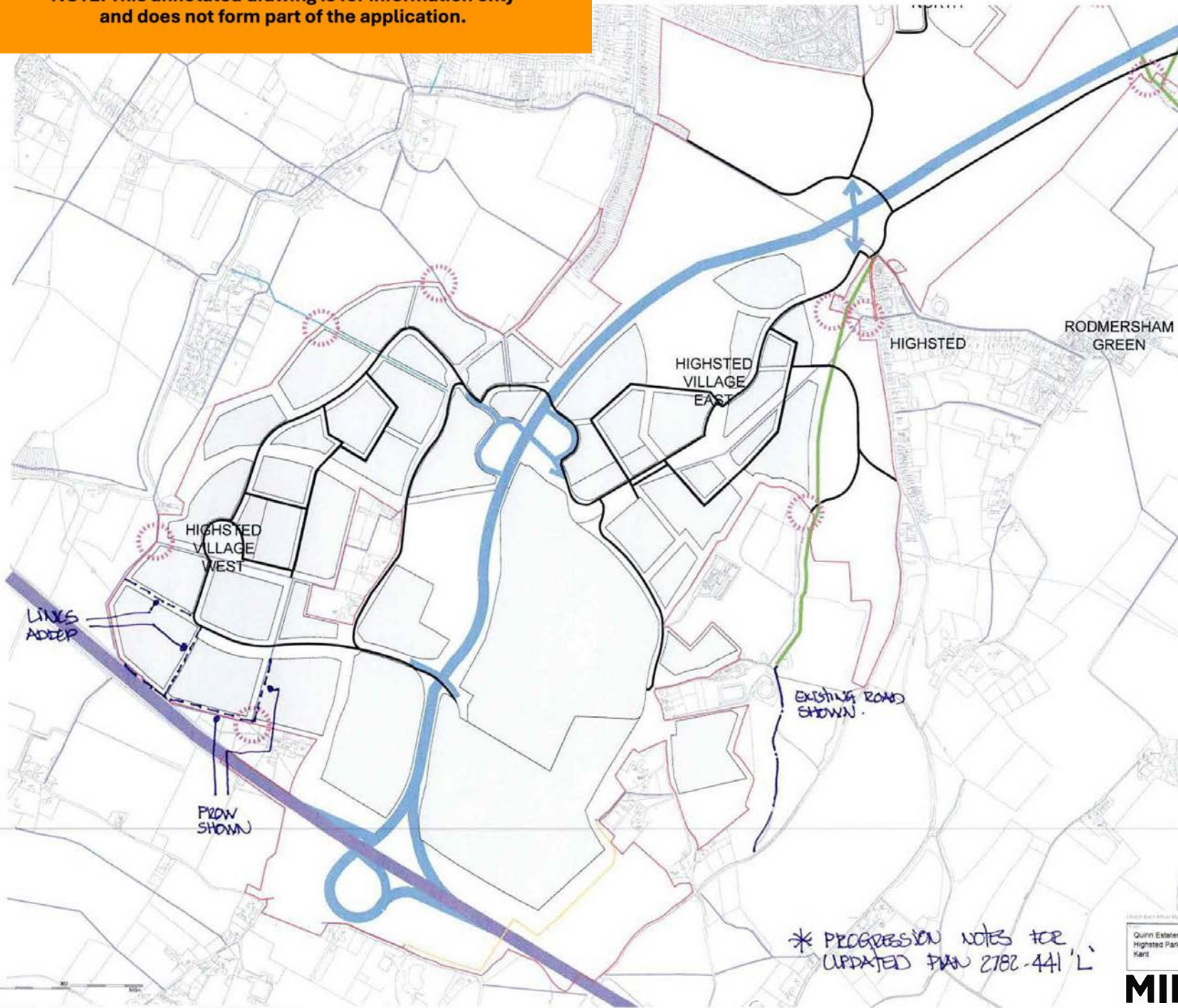

NOTES:

- * PROW BOUNDARIES ADDED
- * ANOMALIES ON PROW DESIGNATION CORRECTED
- * ANOMALIES ON PROW ALIGNMENT ADJUSTED

Key	
	Development Boundary
	Existing Motorway: M2
	Essex A Road: A2
	Southern Relief Road
	Pedestrian and Cycle Route
	Public Footpath
	Public Endway
	Restricted Byway
	PROW Re-aligned
	Points of Access: Pedestrian
	Points of Access: Pedestrian and Cycle

* PROGRESSION NOTES FOR UPDATED PLAN 2782-441 'L'

Quinn Estates Ltd Highsted Park, Stingingbourne Kirt	Framework Plan: Pedestrian and Cycle Routes - Highsted 1:5,000 @ A1 March 2021	DCH 2782-441K
--	--	------------------

MILTON STUDIO



NOTE: This annotated drawing is for information only and does not form part of the application.

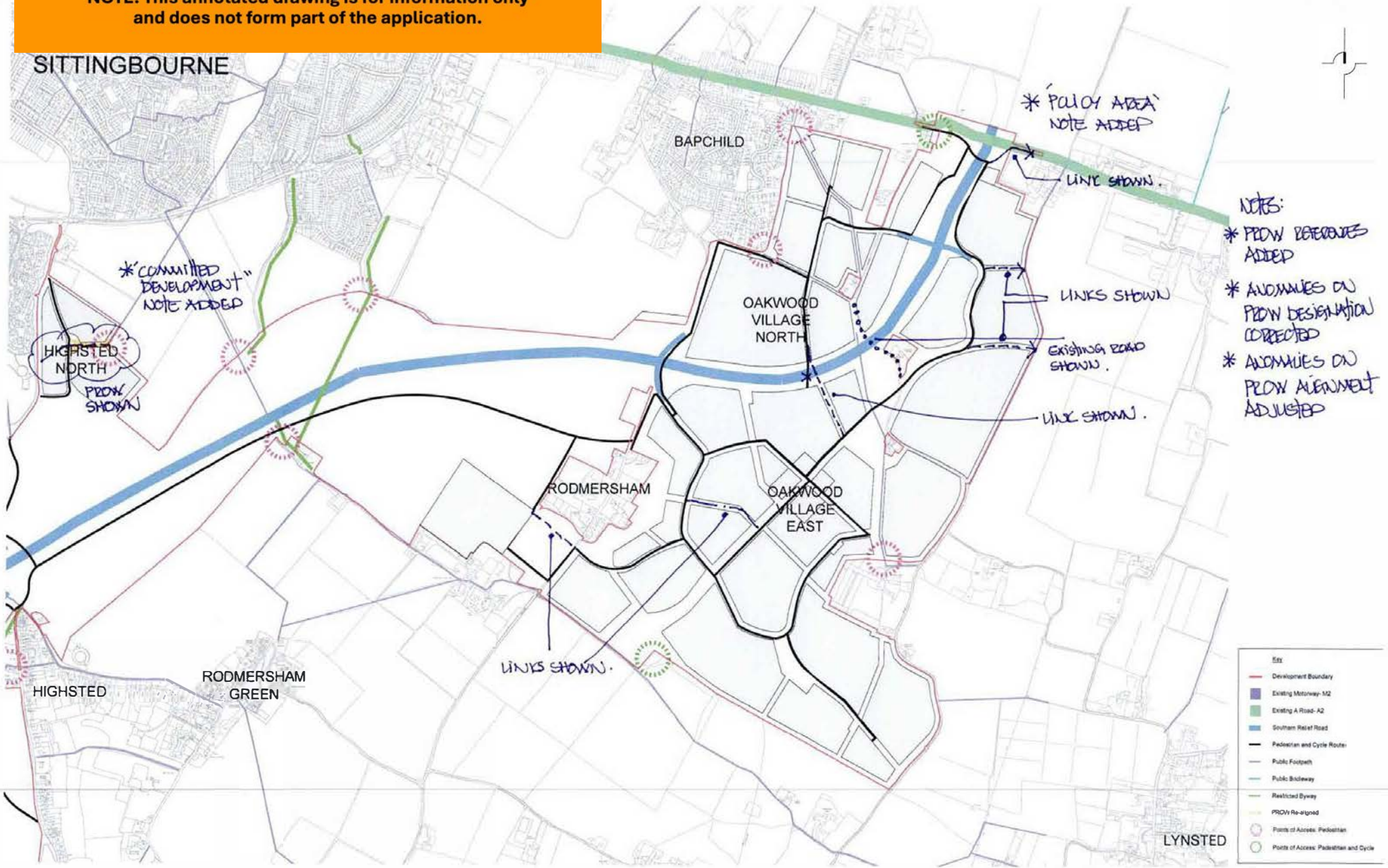

- NOTES:**
- * PROW REVERSES ADDED
 - * ANOMALIES ON PROW DESIGNATION CORRECTED
 - * ANOMALIES ON PROW ALIGNMENT ADJUSTED

* PROGRESSION NOTES FOR UPDATED PLAN 2.782-442 'L'

Quinn Estates Ltd Highsted Park, Sittingbourne Kent	Framework Plan Pedestrian and Cycle Routes - Caxwood 1:5 000 @A1 March 2021	DCR 2782-442K
---	---	------------------

MILTONSTUDIO

